

Algas/SDI



### ALGAS-SDI DIRECT FIRED VAPORIZERS

Requiring no electricity, the Direct Fired vaporizer utilizes LPG itself as its source of energy and provides a constant supply of LPG, regardless of the LPG composition. Algas-SDI's line of Direct Fired vaporizers is designed and constructed to withstand the harshest of conditions. The units include time tested and proven components and a heavy gauge, powder coated steel cabinet, making them exceptionally rugged and ready for all conditions and applications. ASME / UL / CE

RMI Part No.	Capacity		Dimensions			Liquid Inlet	Vapor Inlet	Weight (Lbs.)
	GPH	MMBTU /HR	Depth	Width	Height			
40/40H	40	3.64	22	21	41	3/4"	1"	155
80/40H	80	7.28	35	21	41	3/4"	1"	220
120/60H	120	10.92	35	21	50	3/4"	1"	275
160H	160	14.5	20	30	70	3/4"	1"	450
320H	320	29.1	34	30	74	2"	2"	900
480H	480	43.6	49	30	74	2"	2"	1350
640H	640	58.2	63	30	74	2"	2"	1800
800H	800	72.8	78	30	74	2"	2"	2250

#### REPAIR KITS

RMI Part No.	Description
40631	40/40H Master Rebuild Kit
40633	80/40H Master Rebuild Kit
40634	120/60H Master Rebuild Kit
40480	160H Master Rebuild Kit
3-0034	40/40H Repair Kit
3-0035	80/40H Repair Kit
41040	120/60H Repair Kit
3-0014	40/40H Pilot Orifice & Thermocouple
3-0013	80/40H Pilot Orifice & Thermocouple
41041	120/60H Pilot Orifice & Thermocouple
34812	160H Pilot Orifice
42015	40/40H, 80/40H, & 120/60H Tubing Kit
40466	160H Tubing Kit



DIRECT FIRED VAPORIZER

### TORREXX ELECTRIC VAPORIZER

TORREXX™ defines the industrial standard for dry electric LPG vaporizers. Heater control is through the use of solid state relays or a robust contactor (depending on the capacity of the model). In the event of a "high liquid level occurrence," the proprietary Liqui-Safe Valve™ prevents liquid LPG from passing downstream of the vaporizer. The valve provides visual indication of activation. This allows easy troubleshooting and assures the end-user the device is functioning properly.

RMI Part No.	Vaporization Gallon/Hr.	Capacity BTU/Hr.	Liquid Inlet	Vapor Outlet	Dimensions			Weight (Lbs.)
					D	W	H	
TX25	12.5	1.14 MM	3/4" FNPT	1" FNPT	11-1/4"	9-1/8"	41"	50
TX50	25	2.28 MM	3/4" FNPT	1" FNPT	11-1/4"	9-1/8"	41"	65
TX100	50	4.55 MM	3/4" FNPT	1" FNPT	11-1/4"	9-1/8"	41"	70
TX160	80	7.28 MM	3/4" FNPT	1" FNPT	11-1/4"	9-1/8"	41"	110
TX240	120	10.93 MM	3/4" FNPT	1" FNPT	11-1/4"	9-1/8"	41"	140
TX320	160	14.57 MM	3/4" FNPT	1" FNPT	11-1/4"	9-1/8"	41"	160



TORREXX



TXLSVWI

#### ACCESSORIES

RMI Part No.	Description
41051	Economy Operation Valve
36923	Valve & Strainer Package
20437	Stand - 12" Rise
5010-3003	Drain Valve Kit
64004	Balancing Orifice
34877	Pipe-Away Adapter
TXLSVWI	Liqui-SAFE Valve Wrench

**Algas/SDI**



**PARTS FOR ALGAS DIRECT FIRED VAPORIZERS**

Key	Description	40/40H	80/40H & 120/60H	160H-800H
1	Burner Manifold	1502-4020	-	41091
2	Burner tip #69 burner jet orifice	34447	34447	41092
3	Capacity control valve 1"	1508-4001	1508-4001	1508-4001
4	Drip leg kit	40403	40403	40450
5	Liquid inlet valve	40455	40455	40455
6	Pilot assembly with thermocouple	40774-6	-	40449
7	Pilot flame Guide	1502-5010	-	-
8	Regulator, Burner Supply	34800	34800	34800
9	Relief valve, 3/4" NPT UL/CE/ASME	34876	34876	34876
10	Thermocouple	37050-6	37050-6	THE0001-00-3
11	Thermostat/Thermowell w/9VDC igniter	41073-6	41073-6	41082
12	Tube kit, burner regulator supply	40542	40542	-
13	Tube kit, burner supply	42012	42012	40475
14	Tube kit, capacity control	42013	42013	40467
15	Tube kit, pilot supply	42014	42014	40469
16	Vent cap assembly	40995	40995	-
17	Burner manifold left	-	1501-4020	-
18	Burner manifold right	-	1501-4021	-
19	Pilot assembly with thermocouple	-	40768-6	-
20	Pilot flame guide	-	1501-5086	-
21	Piston, Capacity control valve (Not Shown)	1508-5005	1508-5005	1508-5005
22	Repair kit, Capacity control valve (Not Shown)	40764-12	40764-12	40764-12
23	Repair kit, Liquid Inlet valve (Not Shown)	40764-12	40764-12	40764-12
24	Strainer w/ Magnet, 3/4" NPT (Not Shown)	40776	40776	40776
25	Tube kit, burner manifold connector	-	3-0783	-
26	Tube, heat exchanger connector	-	3-0792	-
27	Tube kit, thermostat supply	-	-	40408

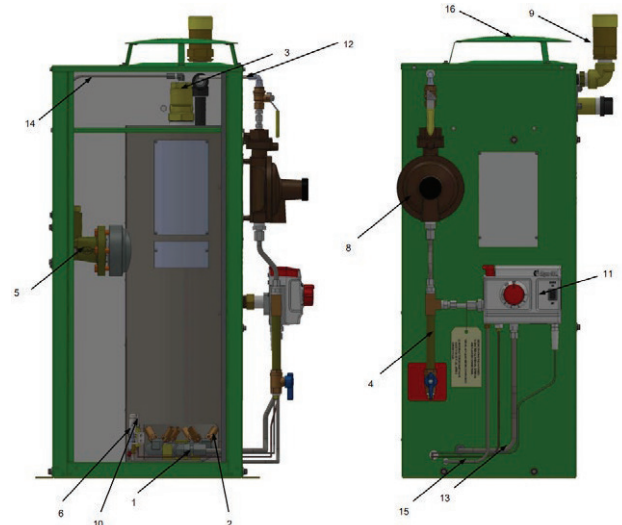

**40/40 DIAGRAM**

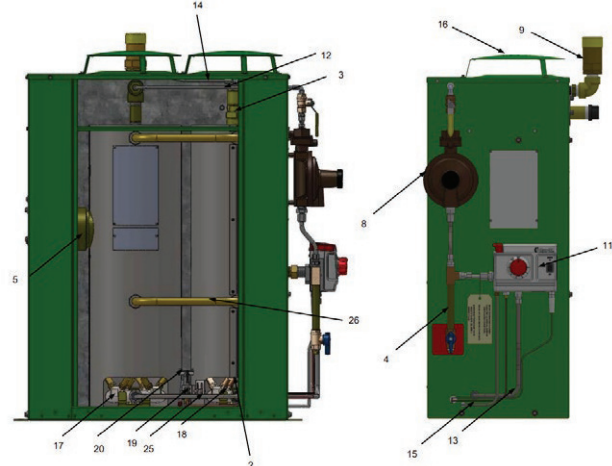

**80/40 & 120/60 DIAGRAM**

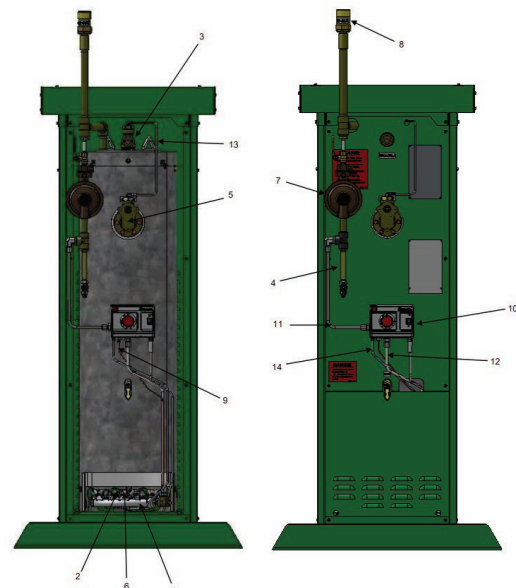

**160H DIAGRAM**



Non-stock/special order items are not cancellable or returnable

Shop online at [www.raymurray.com](http://www.raymurray.com) or call **800-628-5044**

**Algas/SDI**



**TORREXX PARTS**

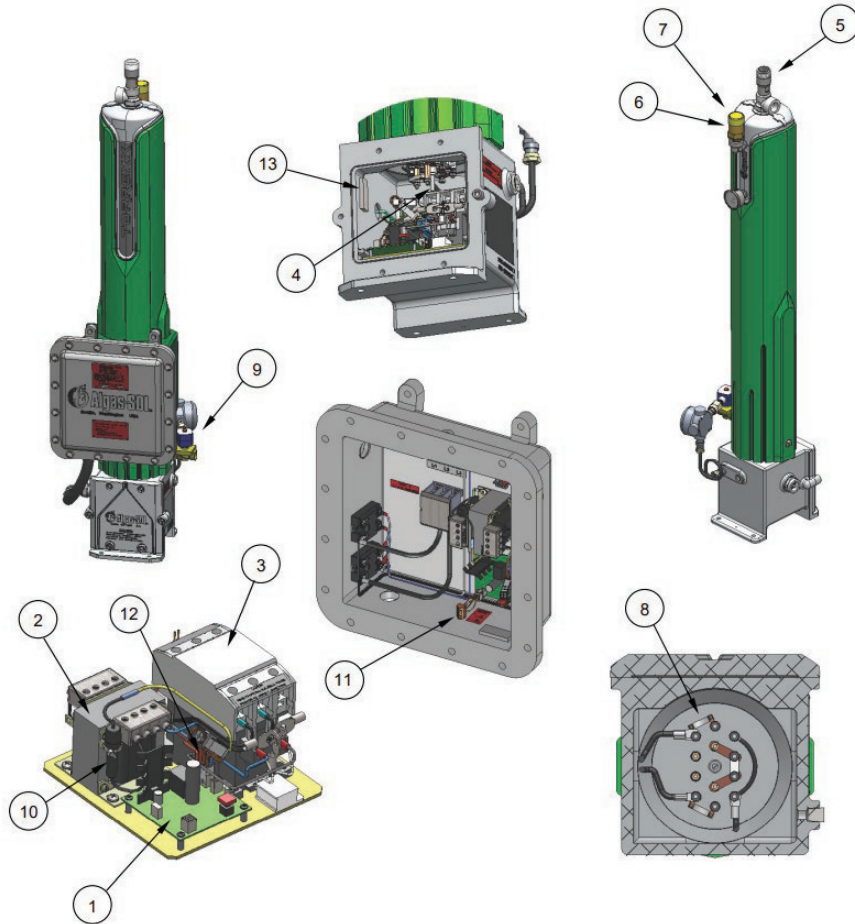

Key	Description	RMI Part No.	Models
1	Temperature Control Board	40888	All
2	Transformer	52605-01	120V Models
		40947	208V Models
		40948	220/240V Models
		40949	380/400/415V Models
		40950	440/480V Models
3	Contactors	43630	All
4	Thermocouple	41141	TX25, TX50, TX100
		41142	TX160
		41143	TX240 w/ Contactor
		41144	TX320 w/ Contactor
		41146	TX240 w/ Mercury Relay
		41147	TX320 w/ Mercury Relay
5	Liqui-SAFE Valve	5001-3003	All
6	Pressure Relief Valve	34876	All
7	Rain Cap for Relief Valve	35379	All
8	Fusible Link	33139-12	All
9	Inlet Solenoid	36111	All
10	Transformer Fuse	50280-2	All
11	Thermocouple Transition Harness	53823	All
12	Main Wire Harness	53820	All
13	Corrosion Inhibiting Tape	42024	All

**TORREXX REPAIR KITS**

RMI Part No.	Description
40869	Economy Valve Maintenance Kit
40287	Inlet Solenoid Kit
40421	Liqui-SAFE Valve O-Ring Kit

Algas/SDI



**ZIMMER ELECTRIC VAPORIZER**

The ZIMMER is a dry-electric LPG or Propane vaporizer that adds energy to vaporize liquid fuel when the amount of energy available from the natural environment is insufficient for vaporization.

- Trouble Free Vaporizer
- 98% Thermal Efficiency
- Multiple Mounting Options
- Various Voltage Configurations
- 20 Gallon Per Hour
- UL listed
- Class 1 Div 1 Group D
- Can utilize 100# and 420# Cylinders



ZIMMER VAPORIZER

**ACCESSORIES**

**VAPORIZERS**

RMI Part No.	Description	Capacity BTU/hr
Z40P-V1-R3	20 GPH Electric Vaporizer	1.8 MM
Z100P-V1-R4	50 GPH Electric Vaporizer	4.5 MM
Z150P-V1-R4	75 GPH Electric Vaporizer	6.8 MM

RMI Part No.	Description
80887	Tank Mounting Kit
80888	Tank Mounting Valve & Regulator Kit
80885	Wall Mount Kit
80892	Strainer & Pipe Kit for Wall Mount

**AQUAVAIRE VERTICAL GAS FIRED WATERBATH VAPORIZERS**

Algas-SDI AQUAVAIRE vaporizers set the industry standard with their proven long-term reliability in all weather conditions. These rugged, but refined, gas fired waterbath vaporizers take the beating of continuous or occasional use whether it be at an industrial facility or at a ski resort in the mountains.



AQUAVAIRE VAPORIZER

RMI Part No.	Vaporization Gallon/Hr.	Capacity BTU/Hr.	Liquid Inlet	Vapor Outlet	Electrical Data			Dimensions			Weight (Lbs.)
					Phase	Voltage	Amps	D	W	H	
Q320V	320	29,120,000	3/4" NPT	2" NPT	1	120	8.9	69"	27"	70"	1150
Q480V	480	43,680,000	3/4" NPT	2" NPT	1	120	8.9	72"	27"	79"	1350
Q640V	640	58,240,000	3/4" NPT	2" NPT	1	120	10.4	74"	39"	75"	2100
Q800V	800	72,800,000	1" NPT	2" NPT	1/3	120/240	9.1/4.8	74"	39"	88"	2300
Q960V	960	87,360,000	1" NPT	2" NPT	1/3	120/240	11.5/6.2	74"	39"	88"	2400
Q1120V	1120	101,580,000	1" NPT	2" NPT	1/3	120/240	14.5/8.3	92"	55"	83"	7100
Q1375V	1375	125,520,000	1" NPT	2" NPT	1/3	120/240	15.0/8.5	92"	55"	83"	7200

**SECOND SUN TANK HEATER**

Second Sun™ is a flameless catalytic tank heater designed to safely and efficiently augment natural vaporization in propane and LPG storage tanks.

- Add up to 2MM BTUH to tank capacity
- Containers can be stationary or portable
- Flameless Catalytic Heater
- Integrated over pressure and over temperature safeties
- Two Temperature Safety Switches, Upper and Lower

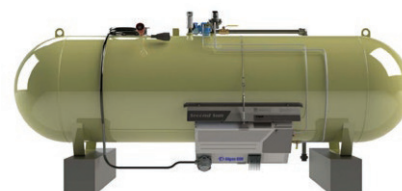

SECOND SUN TANK HEATER

**SECOND SUN Tank Heaters are not for use in multiple tank installations, standby or back-up loads and/or installations for larger loads that should be served by a vaporizer.**

RMI Part No.	Description	Tank Size
SS10P-IEC-V1	10,000 BTU/hr. Tank Heater	500-1,000
SS30P-IEC-V1	30,000 BTU/hr. Tank Heater	1,000-12,000



Non-stock/special order items are not cancellable or returnable

Shop online at [www.raymurray.com](http://www.raymurray.com) or call **800-628-5044**

Ransome

**RANSOME**  
MANUFACTURING

### RANSOME DIRECT FIRED VAPORIZERS

- Mechanical liquid inlet valve provides positive control of LP-Gas liquid level on all RH 50, 80 and RH 120 sizes. Larger sizes use reliable float switch and electric inlet valve to prevent liquid carryover
- Millivolt-powered gas control system maintains consistent vapor temperature under changing load conditions
- Gas control valve is located inside the protective dry cabinet with the regulator mounted on the exterior providing for total ventilation
- Precision operating temperature switch, factory-set and sealed against tampering, incorporates precious metal contacts for extended service life
- Two-stage pressure regulation provides accurate burner gas burner pressures and performance regardless of changes in inlet pressure



**DIRECT FIRED VAPORIZER**

RMI Part No.	W/Electric Relight	Capacity GPH @ 0°F.	Capacity BTU/Hr.	Dimensions			Liquid Inlet	Vapor Inlet	Weight (Lbs.)
				Depth	Width	Height			
RH50	RH50-E	50	4,580,000	20.5"	16.6"	31"	3/4"	1"	205
RH80	RH80-E	80	7,340,000	20.5"	16.6"	41"	3/4"	1"	245
RH120	RH120-E	120	11,000,000	20.5"	16.6"	48.5"	3/4"	1"	285
RH200	RH200-E	200	18,340,000	20.5"	16.6"	67.5"	1"	1"	380
RH400	RH400-E	400	36,680,000	26.3"	34"	64"	1"	2"	920
RH600	RH600-E	600	54,900,000	26.5"	42"	69.5"	1"	2"	1300
RH800	RH800-E	800	73,200,000	26.5"	56"	69.5"	1"	2"	2050
RH1000	RH100-E	1000	91,500,000	26.5"	70"	69.5"	1"	2"	2500

#### EMERGENCY SHUTOFF OPTIONS

"ESV" Options Models	RMI Part No.
RH50-200	XESV0200
RH400	XESV0400
RH600	XESV0600
RH800	XESV0800
RH1000	XESV1000

Units available to accept 3/4" or 1" ESV, add on to part number. Example (RH80-ESV)

#### ELECTRIC PILOT RELIGHTER

"E"Option Models	RMI Part No.
RH50-120	XE0120
RH200	XE0200
RH400	XE0400
RH600	XE0600
RH800	XE0800
RH1000	XE1000

### RANSOME WATERBATH VAPORIZERS

- Mechanical liquid inlet valve provides positive control of LP-Gas liquid level on all RW 100 units. RW180 thru RW900, use a reliable float switch and electric inlet valve to prevent liquid carryover
- Millivolt-powered gas control system maintains proper water bath temperature under changing load conditions
- Gas control valve is located inside the protective dry cabinet with the regulator mounted on the exterior providing for total ventilation
- Precision operating temperature switch, factory-set and tamper resistant, incorporates precious metal contacts for extended service life
- ASME code vaporizing tubes with integral heat exchange vanes and internal water chamber provide efficient vaporization with minimum burner input
- Integral circulating pumps enhance heat transfer and temperature control capabilities



**WATERBATH VAPORIZER**

RMI Part No.	W/Electric Relight	Capacity GPH	Capacity BTU/Hr.	Dimensions			Liquid Inlet	Vapor Outlet	Weight (Lbs.)
				Depth	Width	Height			
RW100	RW100-E	100	9,170,000	20.5"	14"	48.5"	3/4"	1"	450
RW180	RW180-E	180	16,500,000	20.5"	14"	67.5"	3/4"	1"	750
RW360	RW360-E	360	33,010,000	21.5"	28"	69"	1"	2"	1390
RW540	RW540-E	540	49,510,000	21.5"	42"	69"	1"	2"	1950
RW720	RW720-E	720	66,020,000	21.5"	56"	69"	1"	2"	2510



Non-stock/special order items are not cancellable or returnable

Shop online at [www.raymurray.com](http://www.raymurray.com) or call **800-628-5044**

**Ransome**

**RANSOME**  
MANUFACTURING

**DIRECT FIRED PARTS LIST**

Key	Part Description	RMI Part No.							
		RH50	RH80	RH120	RH200	RH400	RH600	RH800	RH1000
1	Vent Cap	36H05	36H05	36H20	36H20	36H20	36H20	36H20	36H20
2	Doughnut Gasket	KMB	KMB	KMB	KMB	KMB	KMB	KMB	KMB
3	Vapor Temp Switch	KF-120F	KF-120F	KF-120F	KF-120F	KF-120F	KF-120F	KF-120F	KF-120F
4	Shutoff Valve	80	80	80	80	80	80	80	80
5	Twin Stg Burner Gas Regulator	R632A-HCF	R632A-HCF	R632A-HCF	R632A-HCF	R632A-JFF	-	-	-
5A	1st Stg Burner Gas Regulator	-	-	-	-	-	R622H-HGJ	R622H-HGJ	R622H-JGJ
5B	2nd Stg Burner Gas Regulator	-	-	-	-	-	R622-CFFXA	R622-CFFXA	HSRL-BFC
6	Vaporizer Tube	10H05	10H08	10H12	10H20	10H20	10H20	10H20	10H20
7	Insulation	KRS (2)	KRS (3)	KRS (4)	KRS (5)	KRS (5)	KRS (5)	KRS (5)	KRS (5)
8	Burner Gas Control Valve	WR-36C03U333	WR-36C03U333	WR-36C03U333	WR-36C03U333	WR-36C03U333	WR-36C03U333	WR-36C03U333	WR-36C03U333
9	LP Gas Drain	1370	1370	1370	1370	1370	1370	1370	1370
10	Pilot Assembly	JC-KIT	JC-KIT	JC-KIT	JC-KIT	JC-KIT	JC-KIT	JC-KIT	JC-KIT
11	Thermal Generator	HW-Q313A	HW-Q313A	HW-Q313A	HW-Q313A	HW-Q313A	HW-Q313A	HW-Q313A	HW-Q313A
12	Rain Cap	RC125	RC125	RC125	RC125	RC125	RC125	RC125	RC125
13	Pipe-Away	MEPS-431	MEPS-431	MEPS-431	MEPS-431	MEPS-431	MEPS-431	MEPS-431	MEPS-431
14	Safety Relief Valve	H185250	H185250	H185250	H185250	H185250	H185250	H185250	H185250
15	Ultrasonic Level Switch	-	-	-	SOR1	SOR1	SOR1	SOR1	SOR1
16	Chamber	-	-	-	ISH10	ISH10	ISH10	ISH10	ISH10
17	Back Check Valve	-	-	-	BCU10	BCU10	BCU10	BCU10	BCU10
18	Inlet Valve	13H00	13H00	13H00	210G027	210G027	210G027	210G027	210G027
19	"Y" Strainer	-	-	-	774	774	774	774	774
20	Burner Ring	12H20-63	12H20-65	12H20-69	12H20	12H20	12H20	12H20	12H20

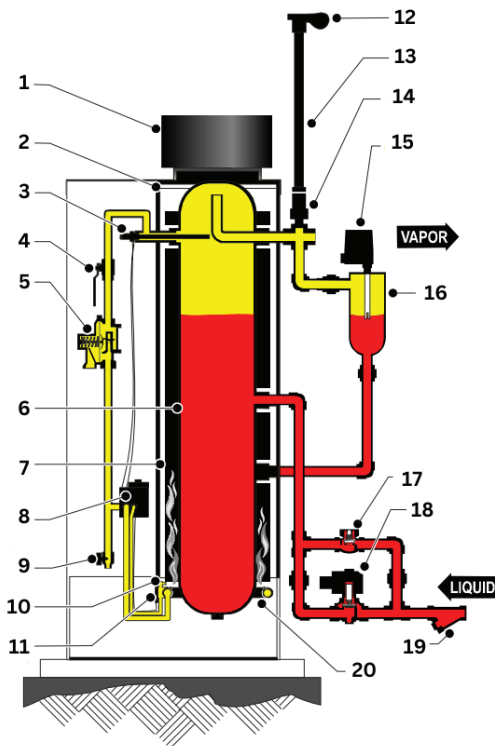

RH200-RH1000 SHOWN

**Featuring: RH Series Direct-Fired LP-Gas Vaporizers**



*With Ransome Manufacturing's full line of gas plant components, you can tailor Ransome equipment to your requirements without compromise. We have over 65 standard production models in our line of vaporizers, vaporizers/mixers and Modulating Proportioning mixers. Standard capacities range from 4½ million to over 1 billion BTU/hr (50 to 11,800 gallons of propane per hour). Two or more units can be combined in parallel to handle any conceivable requirement. Ransome Manufacturing, the only and complete source for LP Gas Backup Equipment worldwide.*



**With over 80 years in the industry...  
...you can Rely on Ransome!**

**RANSOME**  
MANUFACTURING

[www.ransomemfg.com](http://www.ransomemfg.com)

### Separators, Filters, and Additives

#### FILTAIRE OIL DEMISTER

Traps heavy ends commonly present in LPG vapor. The FILTAIRE can be easily installed in either new or existing system with minimal piping changes.

- Permanent filter element to remove contaminants from LPG vapor
- Designed to ASME pressure vessel code
- Unit comes standard with a pressure gauge and drain assembly with plug
- ASME, CRN, and CE marked



FILTAIRE

RMI Part No.	Capacity @ 20 PSIG	Size
20536-ASME	102	1-1/2" NPT
20540-ASME	230	2" NPT
20538-ASME	635	4" 300# Flange

#### HIGH CAPACITY LPG FILTER

Features:

- High-grade forged aluminum body construction
- Durable powder coated exterior
- 5/16-18 UNC tapped mounting holes for easy installation
- 1" hex nut on bottom of bowl for easy maintenance
- Pleated element offers higher contaminant loading capacity and lower pressure drop
- 35 GPM/LPG @ 6.2 PSI pressure differential
- Removes solid contaminants from LPG/NH3 (20 micron rated element)
- 1" FNPT inlet/outlet connections
- 350 PSI maximum pressure
- 1/4" FNPT plugged ports both upstream and downstream of the filter element



ME680-8

RMI Part No.	Description	Inlet	Outlet	Filter Element	Flow Rate
ME680-8	High Capacity Dispensing Filter	1" FNPT	1" FNPT	20 micron	35 GPM/LPG
ME680-ERK	Replacement Filter Element				

#### PRO2000V PROPANE VAPORIZER FUEL TREATMENT

PRO2000-V is a highly effective liquid additive to help eliminate heavy ends in liquid propane. The solvents in Pro200-V allow the heavy ends to be carried into the combustion chamber without creating deposits in control valves and regulators.

RMI Part No.	Description
208L-2.5	2.5 Gallon Container PRO2000-V
208L-55	55 Gallon Drum PRO PRO2000-V



208L-2.5

