

BLACKMER LIQUEFIED GAS PUMPS

Blackmer Liquefied Gas Pumps specifically designed for liquid CO₂ service. High efficiency sliding vane, positive displacement pumps offer the best combined characteristics of sustained high level performance, energy efficiency, trouble free operation and low maintenance cost.

Motor Speed Recirculation Pumps offer capacities from 5 to 22 GPM (depending on differential pressure) and are ideal for loop systems and low volume transfer applications.

Bulk transfer and recirculation Pumps offer capacities from 25 to 300 GPM (depending on differential pressure). These heavy-duty pumps are widely used for bulk transfer and recirculation applications, which include industrial and food preparation systems, refrigeration, process plants and transport loading and unloading.

Blackmer Transfer Pumps for mobile/over the road applications with capacities from 150 to 300 GPM (depending on differential pressure). This pump mounts directly to a commercial control valve in combination with the tank of the transport. Direct mounting eliminates the need for inlet pipes, shutoff valves and external strainer, which can restrict flow and cause vaporization problems.

PUMPS

RMI Part No. Pump & base	Pump only	Inlet/Outlet	HP	Capacity GPM	
				50#	90#
CRLR1.25-DM	CRLR1.25	1 1/4"	2	6 GPM	X
CRL1.25-DM	CRL1.25	1 1/4"	3	11 GPM	7.5 GPM
CRL1.5-DM	CRL1.5	1 1/2"	3	17 GPM	15 GPM
Pump & base	Pump only	Inlet/Outlet		Capacity GPM	
CRL2-DM	CRL2	2"		62	55
CRL3-DM	CRL3	3"		120	95
CRL4-DM	CRL4	4" - 3"		275	245
Transport Pump		Inlet/Outlet		Capacity GPM	
TCRLF4		4" 300# flange/ Twin 2" NPT		275	245

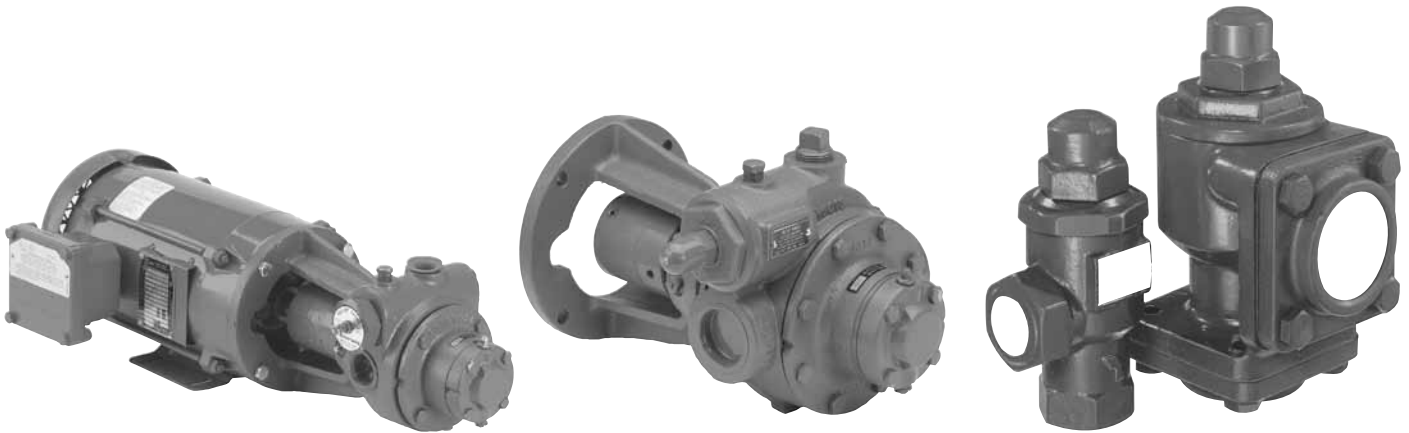

BYPASS VALVES

RMI Part No.	Size	Pump Size	STD PSI Range
BV-3/4	3/4"	1 1/4 - 1 1/2	70-100
BV-1	1"	1 1/4 - 1 1/2	70-100
BV-1 1/4	1 1/2"	1 1/2 - 2"	70-100
BV-1 1/2	3/4"	2 - 3"	90-125
BV-2	3/4"	3 - 4	90-125

BLACKMER BYPASS VALVES

Blackmer Bypass Valves are designed to protect pumps and system components from excessive pressure damage. In operation, Blackmer valves provide exceptional close pressure control, even under widely varying bypass conditions.

© Ray Murray Inc. Edition 11

PUMPS, HOSES & FITTINGS